

 JACOBUS

# Contents

3	JAcobus: at home everywhere
4	An ultra-clean wood-burning stove for optimum living comfort
6	High quality guaranteed
7	The versatile JAcobus
	JAcobus 6 - JAcobus 9 - JAcobus 12
8	JAcobus in a nutshell
9	JAcobus COOK
10	JAcobus TUNNEL
12	JAcobus KWADRAAT
13	Upgrade combustion system
16	JAcobus PELLET
18	Technical data
23	Accessories
24	Janco de Jong BV



## JAcobus: at home everywhere

Janco de Jong in Gorredijk, The Netherlands, has been designing and manufacturing wood-burning stoves since 1981. The renowned JAnus wood-burning stove laid a solid foundation for the current range of stoves, including the JAcobus wood-burning stove, JAcobus KWADRAAT and JAcobus PELLET. Janco de Jong has remained true to its signature style in the design of all of its stoves – sleek, rugged and timeless.

JAcobus stove combines all the strong features of the original JAnus wood-burning stove with a revolutionary combustion technology. Available in a number of sizes and designs, the JAcobus is at home in any interior.



## An ultra-clean wood-burning stove for optimum living comfort

The comfort level in your home is largely determined by a pleasant indoor temperature. The JAcobus wood-burning stove is a convection stove, which means that it ensures optimum distribution of heat around the room.

A JAcobus wood-burning stove is also one of the most environmentally responsible ways to heat a home, particularly when used correctly. Wood is a non-fossil natural product and thus an environmentally responsible source of energy. Burning wood is CO<sub>2</sub> neutral. Unique to the JAcobus is its special, patented combustion system. This offers a number of benefits, including highly effective combustion and very low emissions of CO and fine particulates. The stove complies with stringent European standards.

In a nutshell, if you're keen to combine comfort with environmental responsibility, a JAcobus wood-burning stove is a responsible choice.

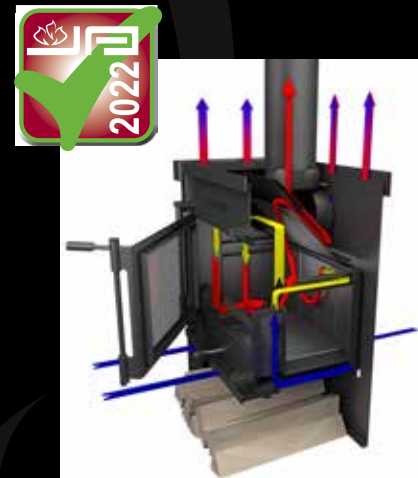

At home everywhere





## High quality guaranteed

The JAcobus wood-burning stove is a genuine Dutch product that owes its origins to many years of experience and craftsmanship. Development of the JAcobus wood-burning stove makes the best use of new technologies and materials. The result is a wood-burning stove that anticipates more stringent emissions regulations while remaining very user-friendly. With its one-button operation, the JAcobus is a very simple to use stove that can be operated by anyone and it does not have easily breakable parts. Over the 40 years that we have been producing wood-burning stoves, we have learned that people very much appreciate this simplicity. Which is why we go as far as granting a lifelong guarantee on the steel and hardware on the stove. The stove is made of Corten steel and the inner walls are made of ceramic bonded pressed fibres. This helps to create a highly insulated combustion chamber. Heat transfer is largely by convection, as well as by radiation on the window side.

## The versatile JAcobus

The JAcobus wood-burning stove is available in various models, each with its own output range, which can be adjusted to match your circumstances. Each model comes fitted with a connection at both the top and rear. In addition, the JAcobus also has options for air supply from outside. Each stove is sand blasted and painted in heat-resistant, anthracite black paint as standard. Your stove can also be fitted with a self-closing door or right-hinged door on request. The JAcobus can be ordered at any height, i.e. above or below the standard height.

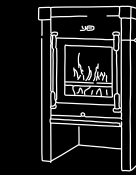

### JAcobus 6

The smallest JAcobus has an output of 3.5 to 7kW and can heat rooms of up to 120m<sup>3</sup>. In addition to the comfort and cosiness that the 'mini' can provide, it has sufficient heat output for most living and accommodation areas.

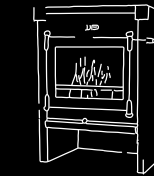

### JAcobus 9

The JAcobus 9 is the mid-range model that in terms of output - will fit into almost any living area. Its output is easy to adjust and ranges from 5 to 10kW, which makes it suitable for rooms starting at 120m<sup>3</sup>.

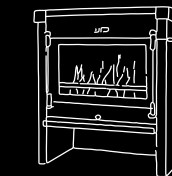

### JAcobus 12

The largest JAcobus is perfect for burning large blocks of wood. With a capacity of 7 to 14kW, the JAcobus 12 is highly suitable for heating a large living room or other space of up to 250m<sup>3</sup>.



## JAcobus in a nutshell

- JAcobus is an ultra-clean wood-burning stove featuring revolutionary, patented combustion technology.
- JAcobus combustion chamber is made from heat-resistant Corten steel to ensure good heat conductivity and a long service life.
- Heat output can be easily adjusted, making the stove suitable for rooms both large and small.
- JAcobus has the option of obtaining combustion air from outdoors as standard, which also makes it suitable for (well-insulated) new-build properties.
- The stove has convenient one-button operation and sets the appropriate ratio of supplied primary, secondary and tertiary (combustion) air itself.
- Any type of wood can be burned in the JAcobus.
- With a unique combustion system, particulate emission of harmful particles is very low.



At home everywhere

## JAcobus cook

### *Old-fashioned home cooking*

A good wood-burning stove gives off so much heat that it seems a shame to use that heat purely to heat the home. With this in mind, we've developed a special cooking stove in the form of a JAcobus wood-burning stove with three cooking plates and an additional protective edge. You can now cook, bake and roast with your wood-burning stove, either indoors or in a covered outdoor location. The JAcobus cook is available with an output of 6, 9 or 12kW and both top and rear outlets.





## JAcobus TUNNEL

### *View from two sides*

This version of the durable JAcobus wood-burning stove has been specially developed upon customers' requests. The stove has the same robust features as other JAcobus models, but has a door with glass on both sides. This means that the stove can be placed beautifully in the centre of a room so that you can fully enjoy the flames in the stove. The JAcobus TUNNEL is available in 3 output versions (6, 9 and 12kW).







At home  
everywhere

## JAcobus KWADRAAT

Janco de Jong has developed a new series of wood stoves: the JAcobus KWADRAAT. As the name implies, the concept is based on the existing JAcobus wood stove. The new models have a sleek design and are available in three different basic variants: a suspended wood stove, a built-in wood stove and a freestanding wood stove. These in turn can act as a front or as a see-through version and are available in 6, 9 and 12kW. The new models from the JAcobus KWADRAAT series are equipped with a top and rear outlet. For the standing model, a concrete cladding is available in various colours.

## Upgrade combustion system

JAcobus KWADRAAT is equipped with an innovative combustion system. It is based on the system that is used in the JAcobus wood-burning stove. Some updates and adapted production techniques have resulted in an even cleaner and more efficient combustion. Additional advantage is that the flue gas temperature of the KWADRAAT series is a fraction higher, minimizing the forming of condensation in the flue gases. The one-button operation is made simpler so that JAcobus KWADRAAT is even easier to use. Because the baffle plate at the top of the combustion chamber has been given a different shape, the afterburning is clearly visible and the flames are enchanting!



## Built-in

The built-in stove is equipped with adjustable feet, allowing you to vary the height at the base of the stove from 350mm to 550mm. A frame is supplied as standard (two with the TUNNEL version) that can be adjusted in the depth direction of the stove. This can serve as support for a Fermacell/ Promatec board or as a 'blunt' frame that can be used to install the stove flush with the surrounding wood. The built-in stove has an intake opening for convection air at the bottom. At the top is an opening around the pipe outlet to allow warm convection air to escape. An optional convection module can be installed to allow you to direct convection heat towards a grille in the housing unit. This module has two connections for a 125mm pipe.

The built-in stove can be supplied as both a front and TUNNEL model in 6, 9 or 12kW with or without a convection module.

Unique features of the built-in stove

- Adjustable installation height
- Heat release by convection and radiation
- Includes finishing strip(s)
- Optional: convection module

## Suspended

The suspended stove can be 'fixed' or 'pivot' mounted to the ceiling, provided that the ceiling structure allows it. The suspended stove comes with a square pipe with the same dimensions of 156x156mm for all output ranges. The length of the square pipe, with fixed or pivoting flange, is determined by the suspension height of the stove and the height of the ceiling and is always custom-made. Please specify the length when ordering. There are invisible handles under the stove that allow the stove to be turned.

The suspended stove can be supplied as both a front and TUNNEL model in 6, 9 or 12kW. Pivoting or fixed.

Unique features of the suspended stove

- Sleek design, particularly with the square pipe
- Suspension height = customised
- Heat release by convection and radiation
- Optional: 360° rotatable

## Freestanding

The freestanding stove has a height of 900mm as standard. The height of the stove is determined by its base, which is available custom-made in any size - not only in an alternative height, but wider than the stove as well. This allows you to create a platform under the stove. The freestanding model in the JACOBUS KWADRAAT range can be clad with mouse grey and anthracite concrete elements. This gives the stove a robust appearance and helps to increase the release of radiant heat.

The freestanding stove can be supplied as both a front and TUNNEL model in 6, 9 or 12kW.

Unique features of the freestanding stove

- Sleeker design than the conventional JACOBUS
- Heat release by convection and radiation
- Stove height adaptable with customisation
- Optional: concrete cladding in several colours

## Concrete

The concrete stove in the JACOBUS KWADRAAT range not only has a unique, robust appearance but also excellent heat conduction and optimal heat storage. The stove is clad in mouse-grey and anthracite concrete elements for comfortable radiant heat output. The concrete undergoes unique treatment during processing to give it a smooth, maintenance-free surface. The concrete-clad stove is supplied as a freestanding version with a height of 945mm.

The freestanding concrete stove can be supplied as both a front and TUNNEL model in 6, 9 or 12kW. The concrete is available in mouse grey and anthracite as standard, other colors are available on request.

Unique features of the concrete stove

- Heat release by convection and radiation
- Concrete cladding is easy to install or retrofit
- Unique looks thanks to warm and robust appearance
- Mouse grey or anthracite concrete cladding



At home  
everywhere



## Jacobus PELLET

Jacobus PELLET has the looks of the true Jacobus wood-burning stove while being fired by pellets. The Jacobus PELLET stoves have a very high efficiency – the ratio of fuel to oxygen is automatically and optimally regulated. This makes the Jacobus PELLET a sustainable alternative to gas-fired heating systems. Jacobus PELLET is a compact, robust, easy-to-use, maintenance-friendly and very quiet stove with a continuously driven pellet motor and heat output through natural convection. To operate the Jacobus PELLET, there is a choice of a remote control or a simple rotary knob on the stove.

The Jacobus PELLET is equipped with a top and rear outlet.

A nice addition to your interior – heat with ease and enjoy pleasant warmth by a cosy fire.

	JAcobus 6	JAcobus 9	JAcobus 12	Remarks
	JAcobus 6 COOK	JAcobus 9 COOK	JAcobus 12 COOK	
	JAcobus 6 TUNNEL	JAcobus 9 TUNNEL	JAcobus 12 TUNNEL	
Dimensions stove: HxWxD (mm)	780x520x380	780x620x380	780x720x380	
	870x540x350	870x580x350	870x680x350	
	780x520x390	880x620x390	880x720x390	
Dimensions external air supply: F/P (mm)	165 / ≥370	165 / ≥370	165 / ≥370	Distance between wall and stove min. 150mm
Dimensions cooking plate LxA (mm)	920x530	920x530	920x530	
Diameter stainless steel cooking plates økr (mm)	3pcs. 138	2pcs. 138, 1pc. 157	2pcs. 138, 1pc. 157	With top connection only 2 instead of 3 cooking plates
Dimensions flue exhaust øD/h1/h2 (mm)	131 / 625 / 120	150 / 625 / 120	150 / 625 / 120	Top and rear connection available
	131 / 725 / 130	150 / 725 / 130	150 / 725 / 130	Top and rear connection available
	131 / - / -	150 / - / -	180 / - / -	TUNNEL top connection only
Nominal output (kW)	6	8,5	12	
Usable output (kW) min - max	3,5 - 7	5 - 10	8 - 14	
Capacity (m³)	60 - 120	120 - 160	160 - 250	
Efficiency (%)	80,5 <sup>1)</sup> / 83,6 <sup>2)</sup> / 89,3 <sup>3)</sup>	76,5 <sup>1)</sup> / 80,6 <sup>2)</sup> / 87,4 <sup>3)</sup>	75 <sup>1)</sup> / 81,5 <sup>2)</sup> / 87,1 <sup>3)</sup>	
CO emission 5) (mg/Nm³)	800 (0,06 ppm) <sup>4)</sup>	739 (0,06 ppm) <sup>4)</sup>	585 (0,05 ppm) <sup>4)</sup>	
Fine particulate emission 5) (mg/Nm³)	30 <sup>4)</sup>	40 <sup>4)</sup>	29 <sup>4)</sup>	
Fue l consumption at nominal output (kg/hour)	1,6 <sup>4)</sup>	2,5 <sup>4)</sup>	3,7 <sup>4)</sup>	
Colour	Dark anthracite	Dark anthracite	Dark anthracite	
Combustion chamber material	Corten steel (3-8mm)	Corten steel (3-8mm)	Corten steel (3-8mm)	
Material exterior	Steel (2,5mm)	Steel (2,5mm)	Steel (2,5mm)	
Combustion air	Primary, secondary, tertiary	Primary, secondary, tertiary	Primary, secondary, tertiary	One-button operation
Clean-window system	Yes	Yes	Yes	
'Self-closing' door	Optional	Optional	Optional	
'Right-hinged' door	Optional	Optional	Optional	Standard is left-hinged
Convection heat	Yes, sides and rear (approx. 80%)	Yes, sides and rear (approx. 80%)	Yes, sides and rear (approx. 80%)	
	Yes, sides and rear (approx. 70%)	Yes, sides and rear (approx. 70%)	Yes, sides and rear (approx. 70%)	
	Yes, sides (approx. 50%)	Yes, sides (approx. 50%)	Yes, sides (approx. 50%)	
Radiant heat	Yes, front and top (approx. 20%)	Yes, front and top (approx. 20%)	Yes, front and top (approx. 20%)	
	Yes, front and top (approx. 30%)	Yes, front and top (approx. 30%)	Yes, front and top (approx. 30%)	
	Yes, front and rear (approx. 50%)	Yes, front and rear (approx. 50%)	Yes, front and rear (approx. 50%)	
Standards	EN13240, DIN+, BlmSchV Stufe 2	EN13240, DIN+, BlmSchV Stufe 2	EN13240, DIN+, BlmSchV Stufe 2	
External air supply	Yes, 80 mm (adapter kit required) Through the wall or floor	Yes, 80 mm (adapter kit required) Through the wall or floor	Yes, 80 mm (adapter kit required) Through the wall or floor	TUNNEL: through floor only
Weight (kg)	110	130	150	
	120	140	160	
	110	130	150	
Warranty	Lifetime on steelwork	Lifetime on steelwork	Lifetime on steelwork	www.jacobus.nl/garantie_voorwaarden

## JAcobus

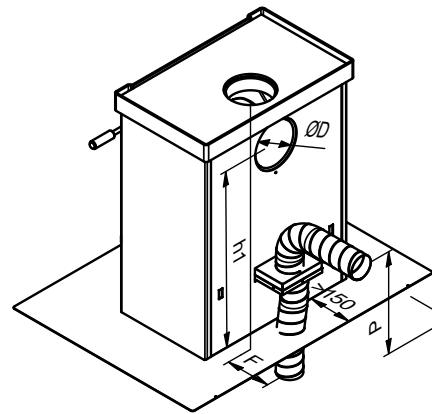
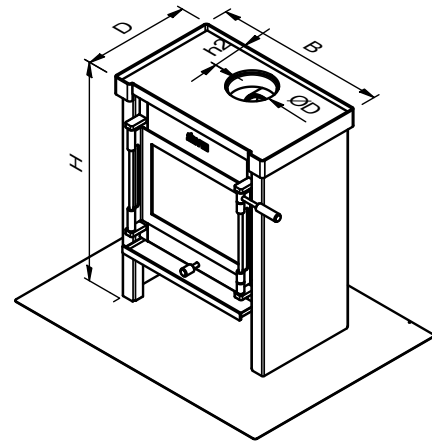

## JAcobus cook

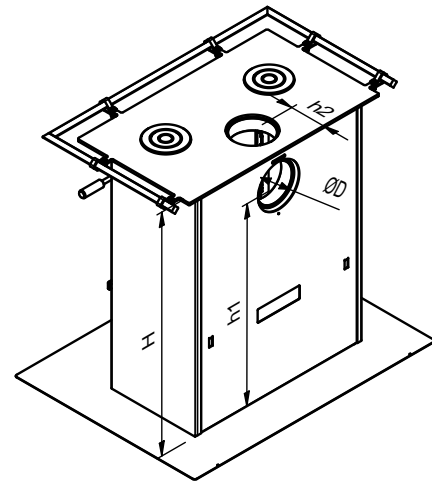
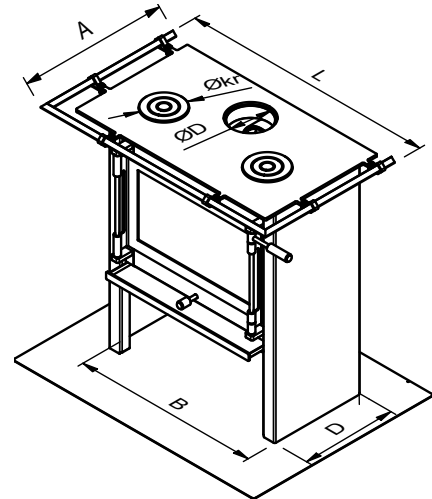

## JAcobus TUNNEL

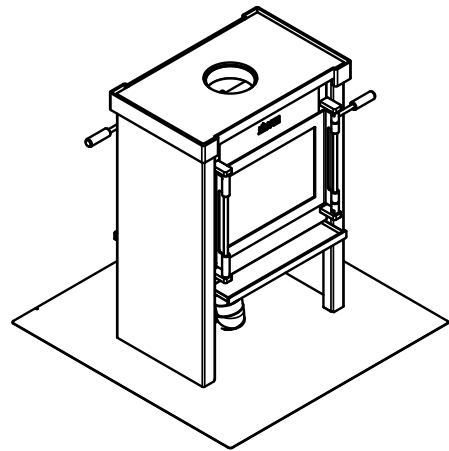
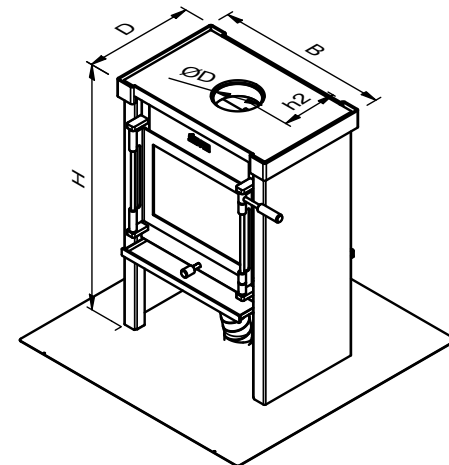

<sup>1)</sup> Efficiency in accordance with standard BlmSchV, Stufe 2, i.e. with very clean combustion.

<sup>2)</sup> Efficiency in accordance with standard BlmSchV, Stufe 1, i.e. with clean combustion.

<sup>3)</sup> Efficiency in accordance with applicable Dutch standard EN13240, i.e. permitted 'polluting' combustion in the Netherlands.

<sup>4)</sup> In accordance with standard BlmSchV, Stufe 2.

<sup>5)</sup> At 13% O<sub>2</sub>.





	JAcobus <sup>2</sup> 6	JAcobus <sup>2</sup> 9	JAcobus <sup>2</sup> 12	Remarks
	JAcobus <sup>2</sup> 6 built-in front	JAcobus <sup>2</sup> 9 built-in front	JAcobus <sup>2</sup> 12 built-in front	
	JAcobus <sup>2</sup> 6 built-in TUNNEL	JAcobus <sup>2</sup> 9 built-in TUNNEL	JAcobus <sup>2</sup> 12 built-in TUNNEL	
	JAcobus <sup>2</sup> 6 suspended front	JAcobus <sup>2</sup> 9 suspended front	JAcobus <sup>2</sup> 12 suspended front	
	JAcobus <sup>2</sup> 6 suspended TUNNEL	JAcobus <sup>2</sup> 9 suspended TUNNEL	JAcobus <sup>2</sup> 12 suspended TUNNEL	
	JAcobus <sup>2</sup> 6 freestanding front	JAcobus <sup>2</sup> 9 freestanding front	JAcobus <sup>2</sup> 12 freestanding front	
	JAcobus <sup>2</sup> 6 freestanding TUNNEL	JAcobus <sup>2</sup> 9 freestanding TUNNEL	JAcobus <sup>2</sup> 12 freestanding TUNNEL	
	JAcobus <sup>2</sup> 6 freestanding front + concrete	JAcobus <sup>2</sup> 9 freestanding front + concrete	JAcobus <sup>2</sup> 12 freestanding front + concrete	
	JAcobus <sup>2</sup> 6 freestanding TUNNEL + concrete	JAcobus <sup>2</sup> 9 freestanding TUNNEL+ concrete	JAcobus <sup>2</sup> 12 freestanding TUNNEL + concrete	
Dimensions stove: HxWxD (mm)				
	628x476x358 (with frame 680x508x358)	628x579x358 (with frame 680x611x358)	628x682x358 (with frame 680x714x358)	Frame is 15mm high and 15mm deep
	628x476x358 (with frame 680x508x358)	628x579x358 (with frame 680x611x358)	628x682x358 (with frame 680x714x358)	
	628x476x358	628x579x358	628x682x358	Height to floor depends on length of pipe > customisation
	628x476x358	628x579x358	628x682x358	
	900x476x358	900x579x358	900x682x358	Height adaptable with customisation
	900x476x358	900x579x358	900x682x358	
	945x636x398	945x739x398	945x842x398	Height not adjustable
	945x636x398	945x739x398	945x842x398	
Dimensions external air supply: F/P (mm)	179 / 135	179 / 135	179 / 135	With TUNNEL possible only through floor
Dimensions flue gas outlet øD / h1 / h2(mm)	150mm exhaust optionally possible	130mm exhaust optionally possible	180mm exhaust optionally possible	TUNNEL: only top exhaust possible
	131 / 179	150 / 179	150 / 179	
	131 / 179	150 / 179	150 / 179	
	131 / 725 / 179	150 / 725 / 179	150 / 725 / 179	
	131 / 725 / 199	150 / 725 / 199	150 / 725 / 199	
Nominal output (kW)	6	9	12	
Usable output (kW) min - max	3,5 - 7	5 - 10	8 - 14	
Capacity (m <sup>3</sup> )	60 - 120	120 - 160	160 - 250	
Efficiency (%)	80,5 <sup>1)</sup> / 83,6 <sup>2)</sup> / 89,3 <sup>3)</sup>	77 <sup>1)</sup> / 80,6 <sup>2)</sup> / 87,4 <sup>3)</sup>	76 <sup>1)</sup> / 81,5 <sup>2)</sup> / 87,1 <sup>3)</sup>	
CO emission <sup>5)</sup> (mg/Nm <sup>3</sup> )	800 (0,06 ppm) <sup>4)</sup>	478 (0,04 ppm) <sup>4)</sup>	966 (0,08 ppm) <sup>4)</sup>	
Fine particulate emission <sup>5)</sup> (mg/Nm <sup>3</sup> )	30 <sup>4)</sup>	27 <sup>4)</sup>	24 <sup>4)</sup>	
Fuel consumption at nominal output (kg/hour)	1,6 <sup>4)</sup>	2,5 <sup>4)</sup>	3,7 <sup>4)</sup>	
Colour	Dark anthracite	Dark anthracite	Dark anthracite	
Combustion chamber material	Corten steel (3-8mm)	Corten steel (3-8mm)	Corten steel (3-8mm)	
Material exterior	Steel (2,5mm)	Steel (2,5mm)	Steel (2,5mm)	
Combustion air	Primary, secondary, tertiary	Primary, secondary, tertiary	Primary, secondary, tertiary	One-button operation
Clean-window system	Yes	Yes	Yes	
'Self-closing' door	Optional	Optional	Optional	
'Right-hinged' door	Optional	Optional	Optional	Standard is left-hinged
Convection heat				
	Yes, via convection module, top	Yes, via convection module, top	Yes, via convection module, top	Convection module optionally available
	Yes, top	Yes, top	Yes, top	
	Yes, top	Yes, top	Yes, top	
	Yes, top	Yes, top	Yes, top	
Radiant heat	Yes, window side	Yes, window side	Yes, window side	
Standards	EN13240, Din+, BlmSchV stufe 2	EN13240, Din+, BlmSchV stufe 2	EN13240, Din+, BlmSchV stufe 2	
External air supply	Yes 80mm (adapter kit required) Front: Through the wall or floor See-through: through floor only	Yes 80mm (adapter kit required) Front: Through the wall or floor See-through: through floor only	Yes 80mm (adapter kit required) Front: Through the wall or floor See-through: through floor only	
Weight (kg)	100 With concrete: +100	110 With concrete: +105	120 With concrete: +110	
Guarantee	Lifetime on steelwork	Lifetime on steelwork	Lifetime on steelwork	jacobus.nl/garantie_voorwaarden

## JAcobus<sup>2</sup> built-in

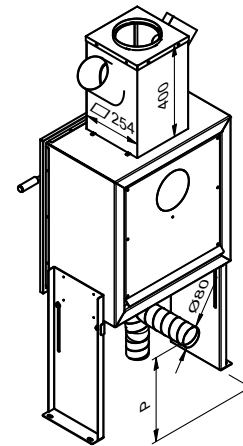
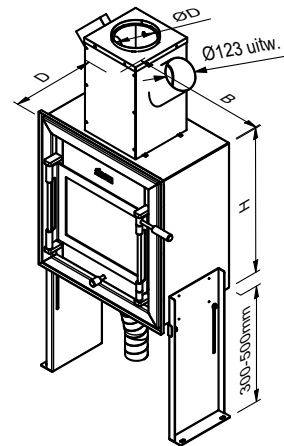

## JAcobus<sup>2</sup> suspended

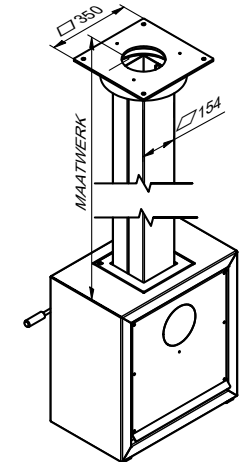
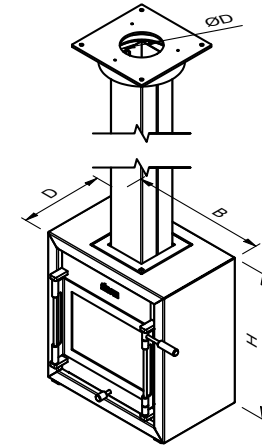

## JAcobus<sup>2</sup> freestanding

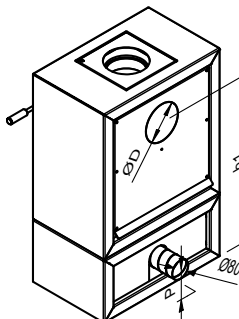
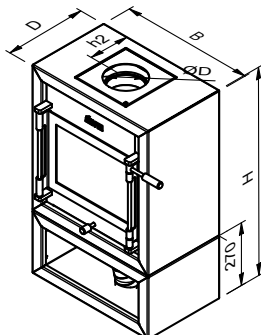

## JAcobus<sup>2</sup> concrete

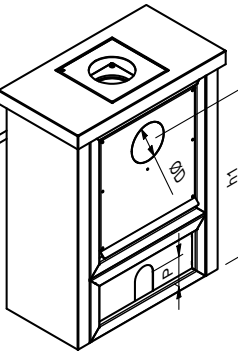
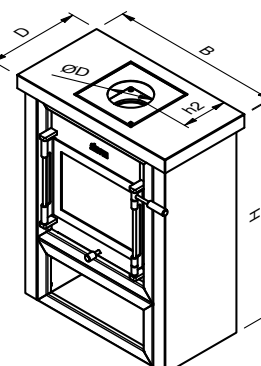

<sup>1)</sup> Efficiency in accordance with standard BlmSchV, Stufe 2, i.e. with very clean combustion.

<sup>2)</sup> Efficiency in accordance with standard BlmSchV, Stufe 1, i.e. with clean combustion.

<sup>3)</sup> Efficiency in accordance with applicable Dutch standard EN13240, i.e. permitted 'polluting' combustion in the Netherlands.

<sup>4)</sup> In accordance with standard BlmSchV, Stufe 2.  
<sup>5)</sup> At 13% O<sub>2</sub>.



	JAcobus PELLET	Remarks
Dimensions stove: HxWxD (mm)	780x512x472	Feet +/- 10mm
Dimensions external air supply: F/P (mm)	- / 225	Only through rear/wall 40mm hose required
Dimensions flue exhaust øD/h1/h2 (mm)	80 / 725-745 / 200	Top and rear connection available
Nominal output (kW)	6	
Usable output (kW) min - max	3,0 - 6,0	
Capacity (m³)	60 - 140	
Flue gas temperature (°C)	122 - 175	
Efficiency (%)	88,5 - 89,1	
CO emission <sup>5)</sup> (mg/Nm³)	144 - 265	
NOx <sup>5)</sup> (mg/Nm³)	110 - 138	
CxHy <sup>5)</sup> (mg/Nm³)	3 - 2	
Fine particulate emission <sup>5)</sup> (mg/Nm³)	14 - 17	
Fuel consumption (kg/hour)	1,3 - 0,63	
Material, maximum dimensions and moisture content of pellets	Wood, Ø 7mm, Length:: 30mm, Moisture < 12 %	
Power consumption (kW)	0,019 - 0,012 (230V-50Hz)	
Current consumption max. short-term (W)	320	
Colour	Dark anthracite	
Combustion air	Primary, secondary, tertiary	
Clean-window system	Yes	
'Self-closing' door	Optional	
Convection heat	Yes, sides and rear (approx. 80%)	
Radiant heat	Yes, front and top (approx. 20%)	
Standards	NEN-EN 16510-2-6:2023	
Weight (kg)	67	
Guarantee	Lifetime on steelwork, remainder 2 years	jacobus.nl/garantie_ voorwaarden

<sup>5)</sup> At 13% O<sub>2</sub>.

## JAcobus PELLET

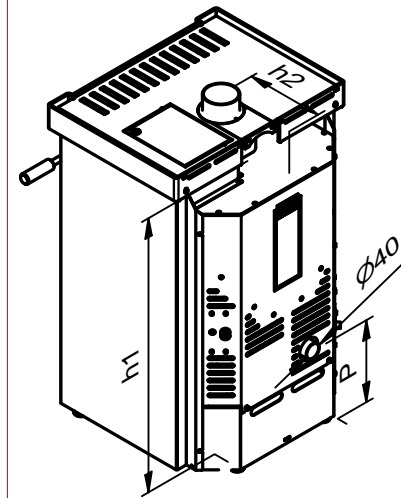
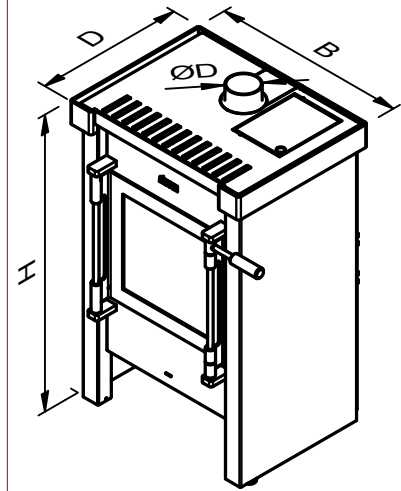

## PELLET technical data

### Accessories

Do you like the design of our stoves? If so, accessories specially designed by Janco de Jong might also interest you. All accessories have been designed to match the contemporary look of our stoves. Each stove comes complete with an ash scoop, a spray can of heat-resistant paint and a handy guide as standard. You can opt to replace the silicone handles on your JAcobus with bakelite handles. You can place a hot plate on your stove to keep a pot of tea warm without damage, and with the special stainless steel hot plate, you can even cook with your stove – or barbecue with the custom-made barbecue grill. We also have a square frying pan, teapot and kettle – all in matching design. We even offer specially designed wood containers and hearth sets. In short, there is a range of fun gadgets to help make your stove even more enjoyable. All accessories are available to order online at: [jastore.nl](http://jastore.nl)





## Janco de Jong BV

Tolbaas 2-10  
8401 GD Gorredijk  
+31 (0) 513 460575  
info@jacobus.nl  
jacobus.nl  
Instagram: Jacobus\_houtkachels  
Facebook: /houtkachels

### Sales through the dealer network

Sales and installation of JAcobus wood-burning stoves are provided by Janco de Jong in Gorredijk, and through an exclusive network of specially selected dealers. You can find our dealers at [jacobus.com](http://jacobus.com)

JAcobus is a legally  
registered trademark  
in the EU (no. 001144808).

2023/3



At home everywhere